

- 1, Coupling guard(No nick)
- 1a, Coupling guard
- 2, Screw M4\*8
- 3, Pump head
- 3a, Lining
- 4, Diffuser
- 4a, Support diffuser
- 4b, Neck ring cover
- 4c, Neck ring
- 5, Coupling
- 5a, Inducer
- 6a, Cutting ferrule type base plate
- 7, Shaft pin
- 8, Nut M12, Washer 12
- 9, Hexagon socket head screw
- 10, Circlip cover
- 22, First impeller cover
- 23, Nut M8, washer 8
- 25, Stay bolt
- 26c, Cutting ferrule type Inlet & outlet chamber
- 28, Drainage screw M10
- 29, Drainage nut
- 30, O ring 136.5\*3.3
- 31, O ring 8\*2.65
- 33, Impeller sleeve(S)
- 34, Mechanical seal
- 36, Air vent nut
- 37, O ring 16\*2.65
- 38, Air vent screw
- 39, Screw, washer
- 40, Motor
- 47, Impeller sleeve
- 47a, Bearing
- 49, Impeller
- 51, Shaft
- 55, Cylinder
- 60, Corrugated spring
- 62, Seal sleeve (only for CDLF4)
- 63, O ring retainer
- 64, Connector
- 65, O ring seat
- 66, O ring
- 67, Discharge diffuser

CDH1, 2, 3, 4-100101

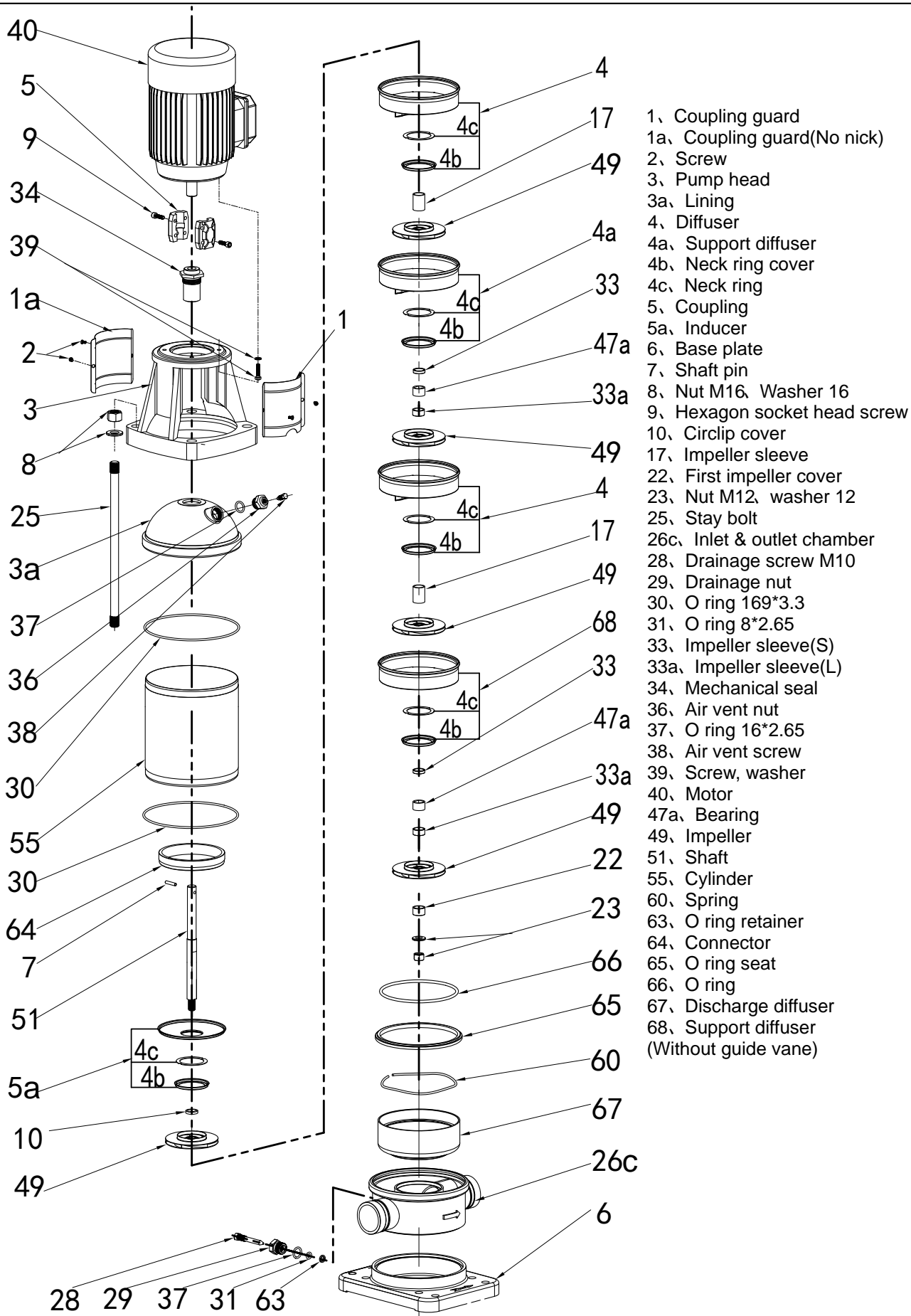

CDH8, 12, 16, 20-100101