



**5 PES 5" STAINLESS STEEL MULTISTAGE
CLOSE-COUPLED SUBMERSIBLE.**
No control panel required for single phase version

Description

5" Submersible multistage centrifugal pump with all components in contact with fluid made in 304 stainless steel , particularly suitable for water distribution Rainwater collection, Irrigation, Dewatering Fountains wash down unit

Design features

Compact close-coupled design, Rust resistant, all components in contact with fluid are made of stainless steel for higher durability, efficiency and best performances.

Easy installation: single phase versions have an internal capacitor and thermal motor-protector thus it is not necessary to connect the pump to a control panel.

Plug in type power cable and level control 20m power cable type H07RN F

Double mechanical-seal

Discharge outlet 1" 1/4

Class F , IP68

Operating Conditions

Max working pressure: 10 Bar

Liquid temperature: -5°C to +40° C

Max immersion depth 20 m

Maximum solids size up to 2mm

Max Sand content: 50 g/m³

Max number of starts per hour: 20

Identification

5 PES (T) 3 / 7 G

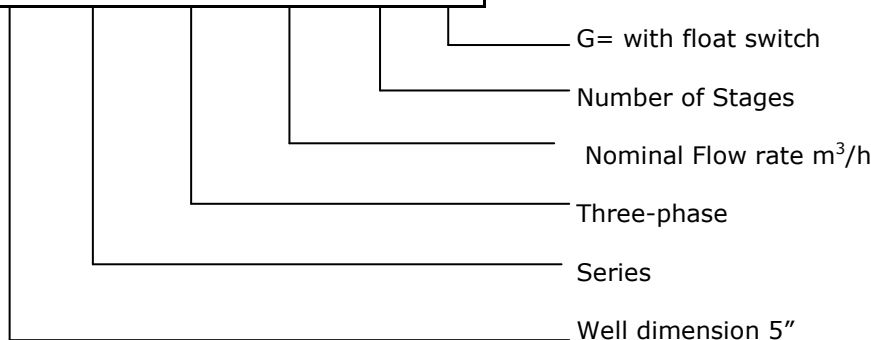

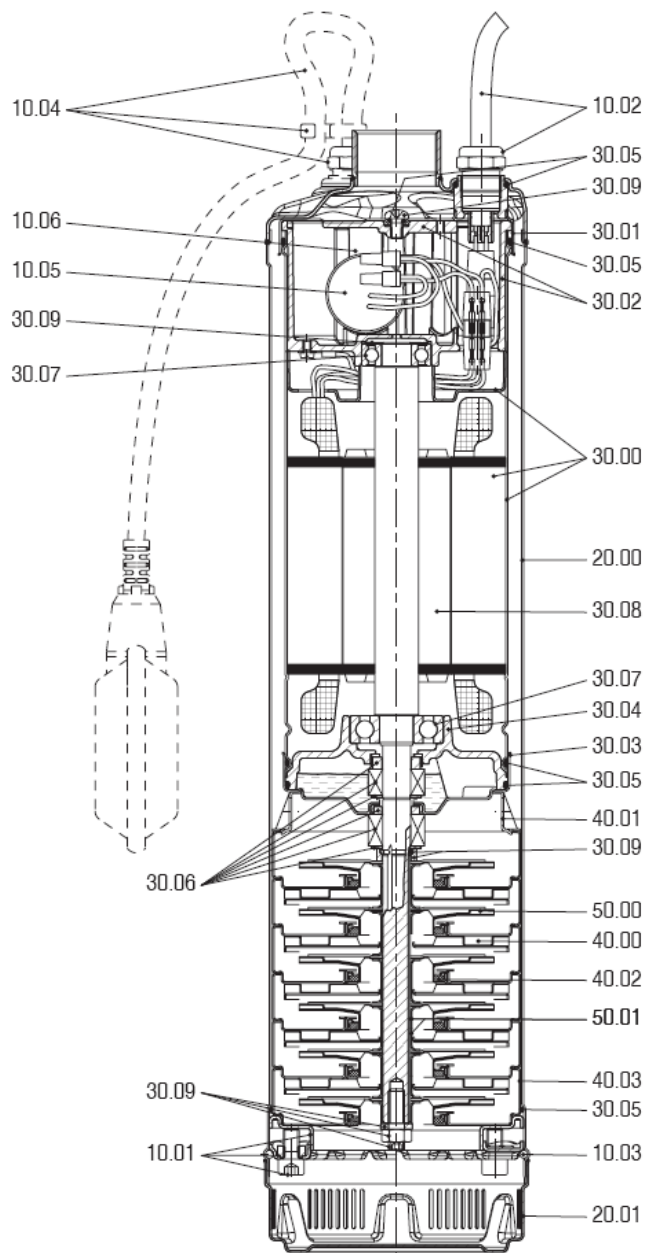

Ref. N.	Description
10 01	Screws and flanges for pre-loading assembly
10 02	Power cable assembly
10 03	Seeger-ring
10 04	Level control assembly
10 05	Capacitor with cables and connectors
10 06	Clamp for capacitor
20 00	Outer case with discharge head
20 01	Suction strainer
30 00	Motor housing and stator
30 01	Upper motor cover
30 02	Upper bearing housing with cover
30 03	Lower motor cover

Ref. N.	Description
30 04	Lower bearing cover
30 05	Kit O-Rings (5 pcs)
30 06	Kit mechanical seals (2 pcs)
30 07	Kit ball bearings (2 pcs)
30 08	Rotor and pump shaft
30 09	Kit screws, nut and washers
40 00	Stage housing and diffuser
40 01	Spacer
40 02	Floating neck ring assembly
40 03	Initial stage housing
50 00	Impeller
50 01	Impeller spacers (2 pcs)

N°	PART DESCRIPTION	MATERIAL	
10.01 / 10.03	Flanges for preloading assembly	Stainless steel	DIN-EN 1.4301 (AISI 304)
20.00	Outer case with discharge head	Stainless steel	DIN-EN 1.4509/1.4301 (AISI 441/304)
20.01	Suction strainer	Stainless steel	DIN-EN 1.4301 (AISI 304)
30.00	Motor housing	Stainless steel	DIN-EN 1.4301 (AISI 304)
30.01 / 30.03	Covers/flanges motor casing	Stainless steel	DIN-EN 1.4301 (AISI 304)
30.08	Pump shaft	Stainless steel	DIN-EN 1.4301 (AISI 304)
40.00 / 40.01 / 40.03	Diffuser/s	Stainless steel	DIN-EN 1.4301 (AISI 304)
50.00 / 50.01	Impeller/s with spacers	Stainless steel	DIN-EN 1.4301 (AISI 304)
30.09	Screws and washers	Stainless steel	DIN-EN 1.4301 (AISI 304)
30.05	O-Ring	NBR	
30.05 / 30.06	Upper mechanical seal	Ceramic/Carbon/NBR	
30.06	Lower mechanical seal	Ceramic/Carbon/NBR	

Performance curves at ~ 2850 rpm

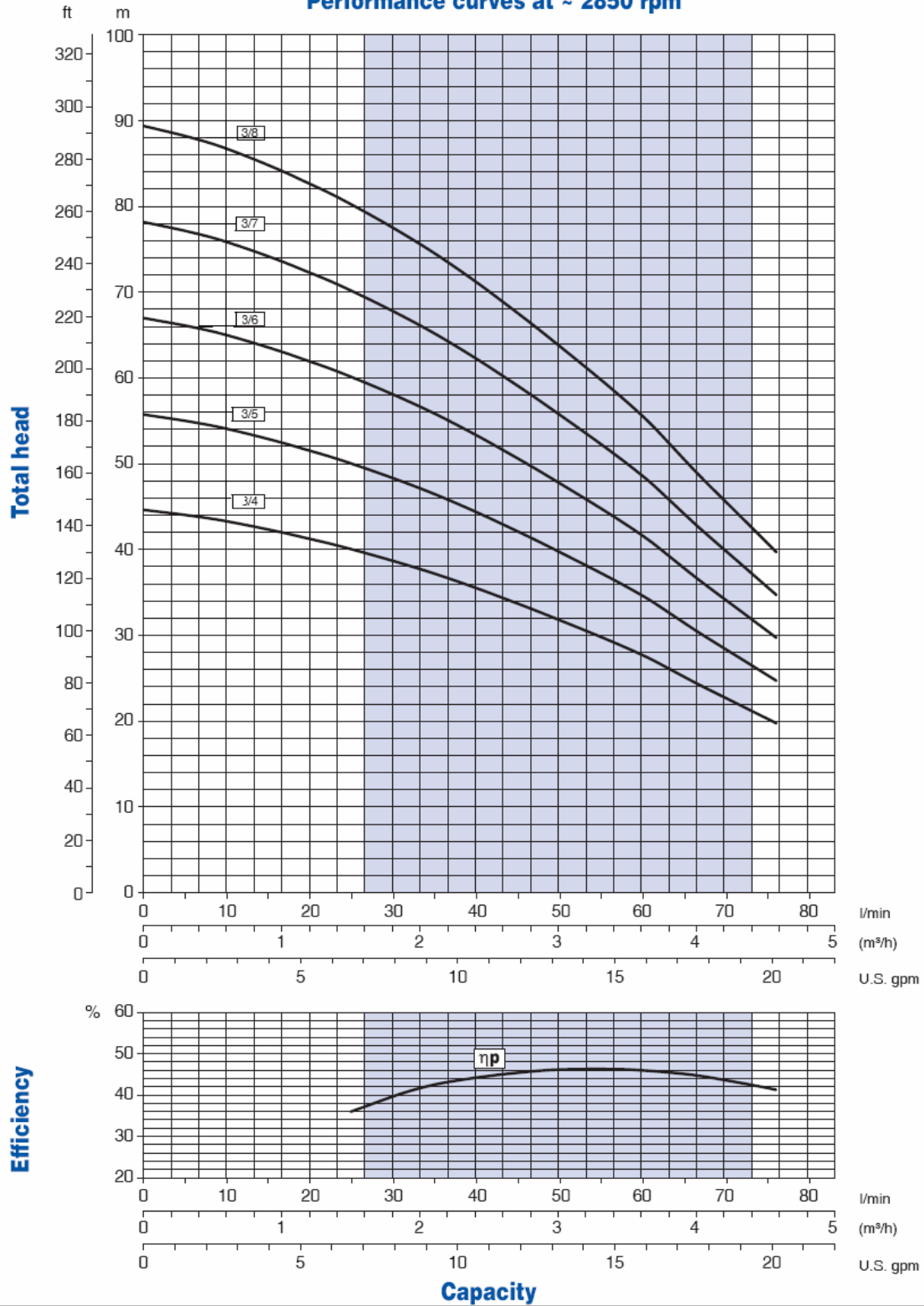

Type	Motor		Internal Capacitor		Rated Current		Q= delivery								
							l/min	0	5	20	30	40	50	60	70
	Kw	Hp	1 ~	3 ~	m³/h	0	0,3	1,2	1,8	2,4	3	3,6	4,2	4,8	
5PES 3/4	0,55	0,75	16	450	4,5	1,9	45		42	39	36	32	28	23	
5PES 3/5	0,75	1	20	450	4,8	2,1	56		52	48	44	40	34	28	
5PES 3/6	0,75	1	20	450	5,6	2,3	67		62	58	54	48	42	34	
5PES 3/7	0,9	1,2	30	450	6,6	2,5	78		72	68	62	56	48	40	
5PES 3/8	1,1	1,5	30	450	7,2	2,7	90		82	78	71	64	56	46	

Single-Phase motors: 220-240 V ±5% / 50Hz . Thermal protection built into the motor
 Three-Phase motors: 380-415 V ± 5% /50HZ . Thermal protection to be provided by the user

Performance curves at ~ 2850 rpm

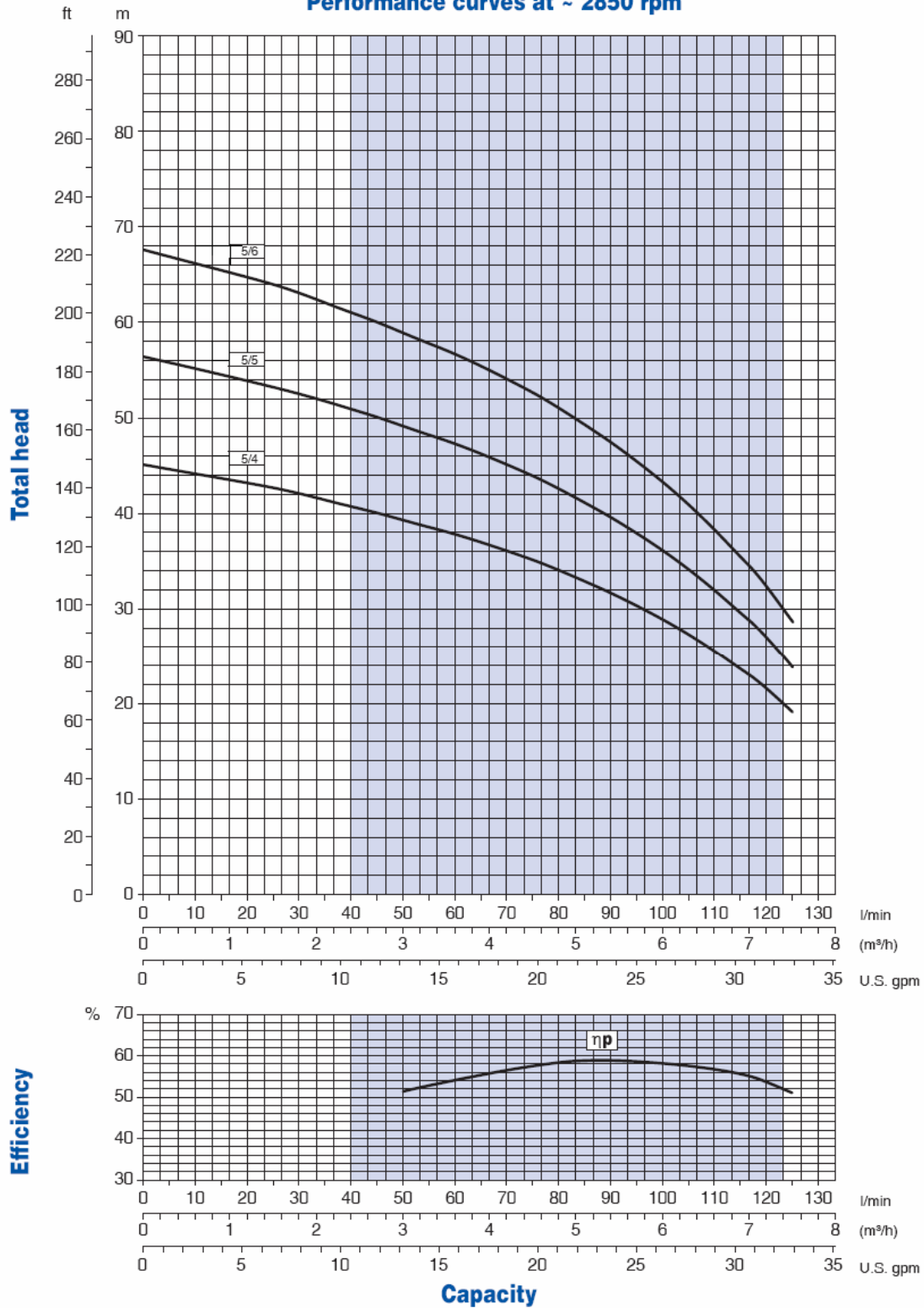

Type	Motor		Internal Capacitor		Rated Current		Q= delivery									
							H= Total Head in Meters									
	Kw	Hp	1 ~ 220-240V	3 ~ 380-415V	l/min 0	5	40	50	60	70	80	100	120			
5PES 5/4	0,75	1	20	450	5,4	2,2	45		41	39	38	36	34	29	22	
5PES 5/5	0,9	1,2	30	450	6,5	2,5	56		51	49	47	45	42	36	27	
5PES 5/6	1,1	1,5	30	450	7,6	2,8	68		61	59	57	54	51	43	32	

Single-Phase motors: 220-240 V ±5% / 50Hz . Thermal protection built into the motor
 Three-Phase motors: 380-415 V ± 5% /50HZ . Thermal protection to be provided by the user

Performance curves at ~ 3420 rpm

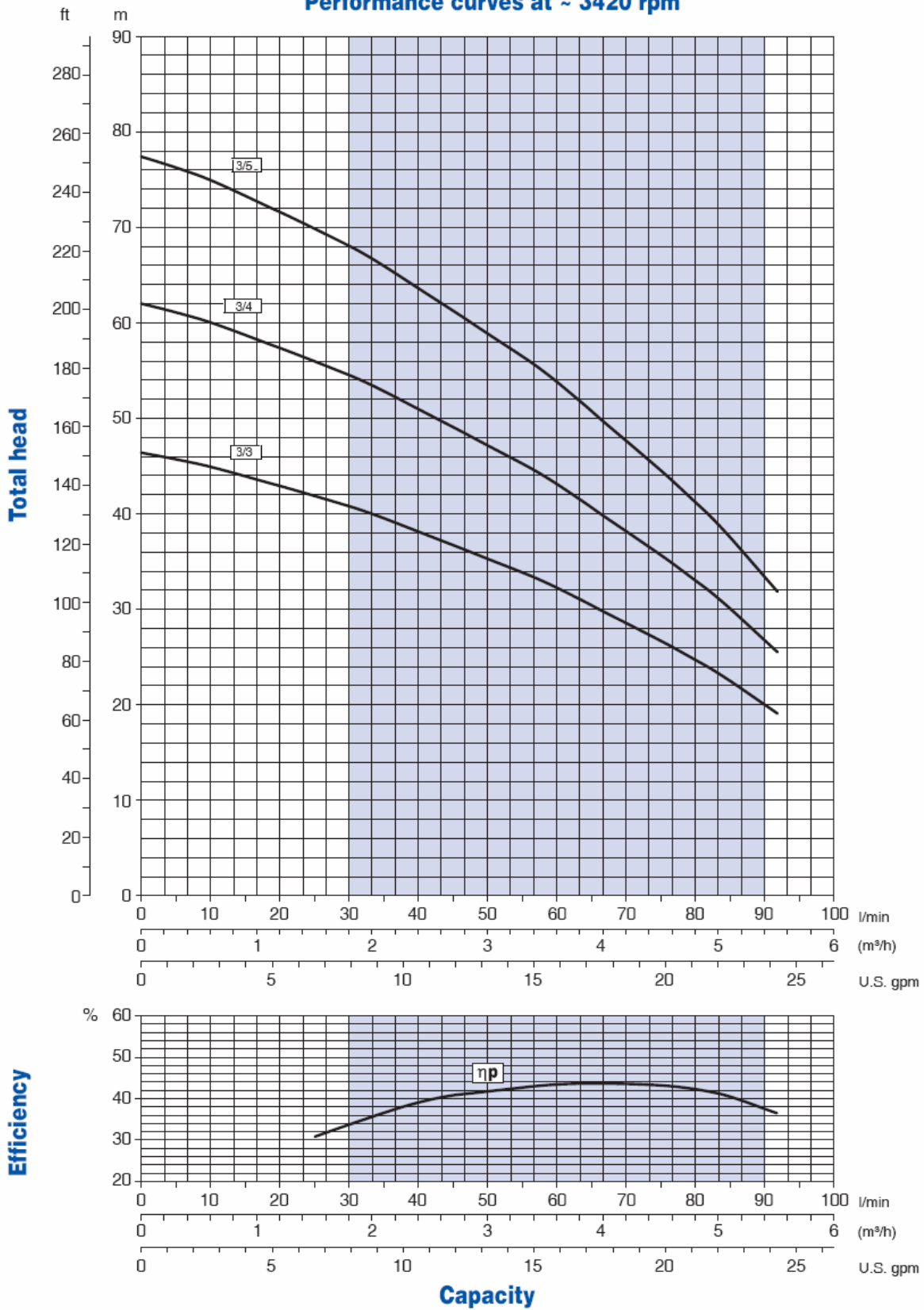

Type	Motor		Internal Capacitor		Rated Current			Q= delivery								
					1 ~		3 ~	l/min	0	5	30	40	50	60	70	80
	Kw	Hp	220-230V	220-230V	380-400V	m³/h	0	0,3	1,8	2,4	3	3,6	4,2	4,8	5,4	
5PES 3/3	0,75	1	20	450	4,9	4,3	2,5	46		41	38	35	32	28	24	20
5PES 3/4	0,9	1,2	20	450	6,4	4,8	2,8	62		55	51	48	43	38	33	27
5PES 3/5	1,1	1,5	25	450	8	6,1	3,5	78		68	64	49	54	48	41	33

Single-Phase motors: 220-230 V ±5% /60Hz . Thermal protection built into the motor

Three-Phase motors: 220-230V or 380-400 V ± 5% /60HZ . Thermal protection to be provided by the user

Performance curves at ~ 3420 rpm

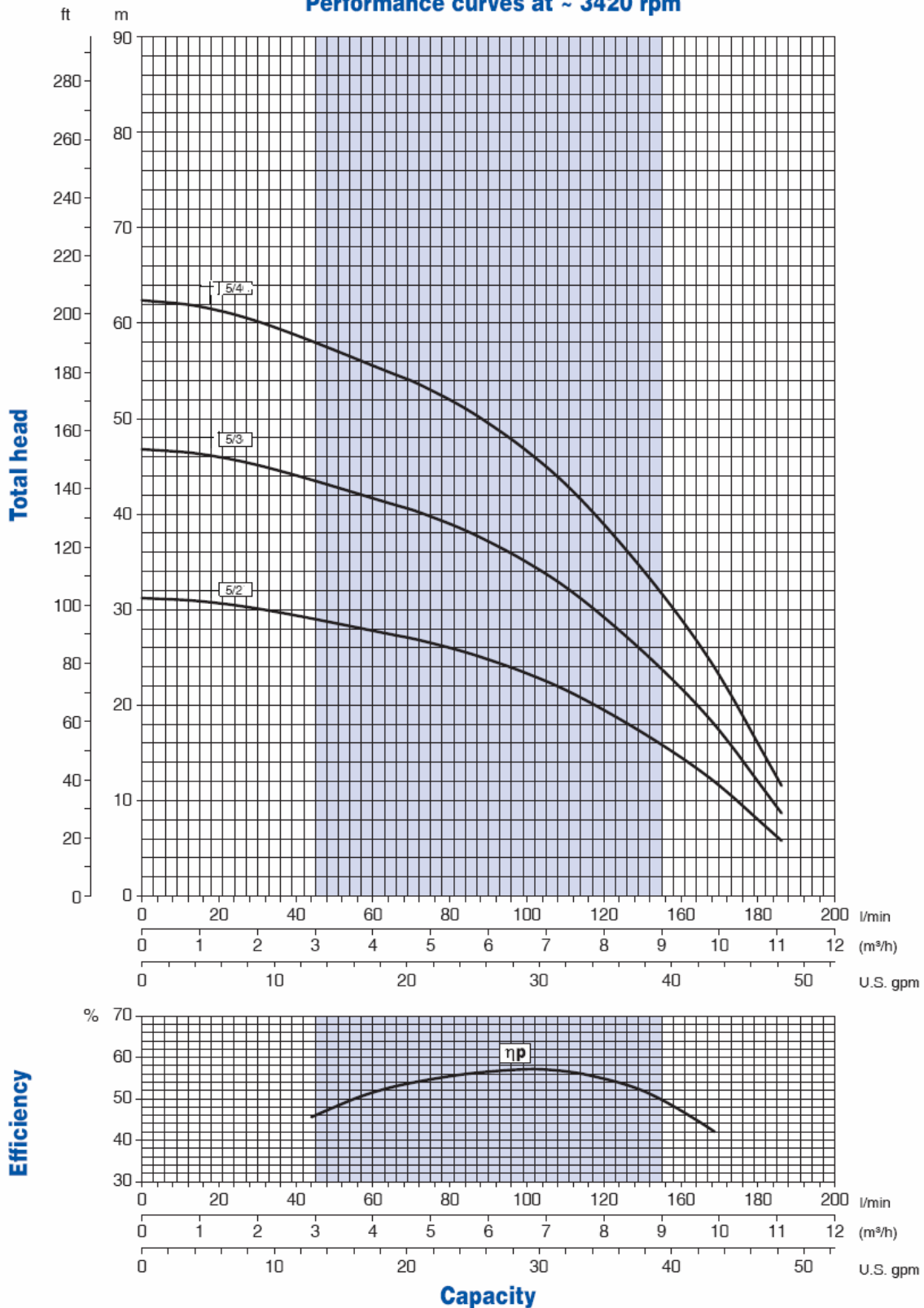

Type	Motor		Internal Capacitor		Rated Current			Q= delivery							
	Kw	Hp			1 ~		3 ~	l/min	0	5	40	60	80	100	120
			220-230V	220-230V	380-400V	m3/h	0	0,3	2,4	3,6	4,2	6	7,2	8,4	
H= Total Head in Meters															
5PES 5/2	0,75	1	20	450	4,7	4,5	2,6	31		30	28	26	24	20	16
5PES 5/3	0,9	1,2	20	450	6,8	5,2	3	47		44	42	39	35	29	22
5PES 5/4	1,1	1,5	25	450	8,9	6,8	3,9	62		59	56	52	47	39	32

Single-Phase motors: 220-230 V $\pm 5\%$ /60Hz . Thermal protection built into the motor

Three-Phase motors: 220-230V or 380-400 V $\pm 5\%$ /60HZ . Thermal protection to be provided by the user